



CAPITAL PROJECTS & PLANNING
2815 East Garland Avenue
Spokane, WA 99207-5889
(509) 354-5775 phone
(509) 354-7178 fax

ADDENDUM NO. 1

September 28, 2020

Request for Qualifications
Architectural & Engineering Services
for
Libby Center Classroom Remodel Project
RFQ No. 3-2021

This Addendum modifies the Request for Qualifications as noted below. This Addendum is applicable to the items affected and all proposers are held responsible for the contents herein.

This Addendum consists of a total of 3 pages.

A. CLARIFICATIONS

1. To supplement the project description noted in Para. 2.2, the attached sheets are hereby provided to show the general limits of the project area within the existing facility.

END OF ADDENDUM NO. 1



LIBBY CENTER
LIBBY CENTER
2900 EAST FIRST AVENUE, SPOKANE WA.

FIRST FLOOR PLAN
SCALE: 1/16" = 1'-0"



PROJ. NO.	485
DATE	01/04/17
PLOT SCALE	
DRAWN	JES
CHECKED	WSF
REVIEWED	
REVISION	11/21/16

FLOOR PLANS

DRAWING NO.
A1-485

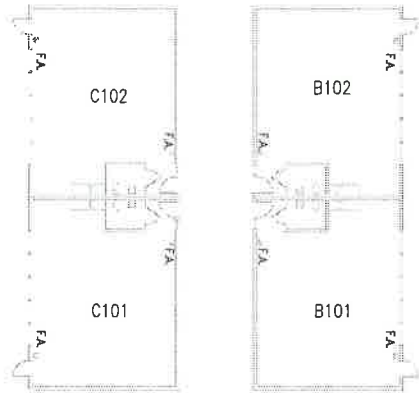

PORTABLE FLOOR PLANS
SCALE: 1/16" = 1'-0"
NORTH

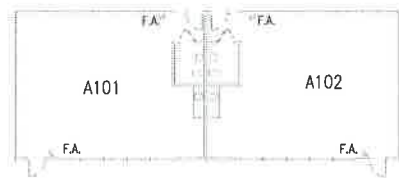

PORTABLE FLOOR PLANS
SCALE: 1/16" = 1'-0"
NORTH

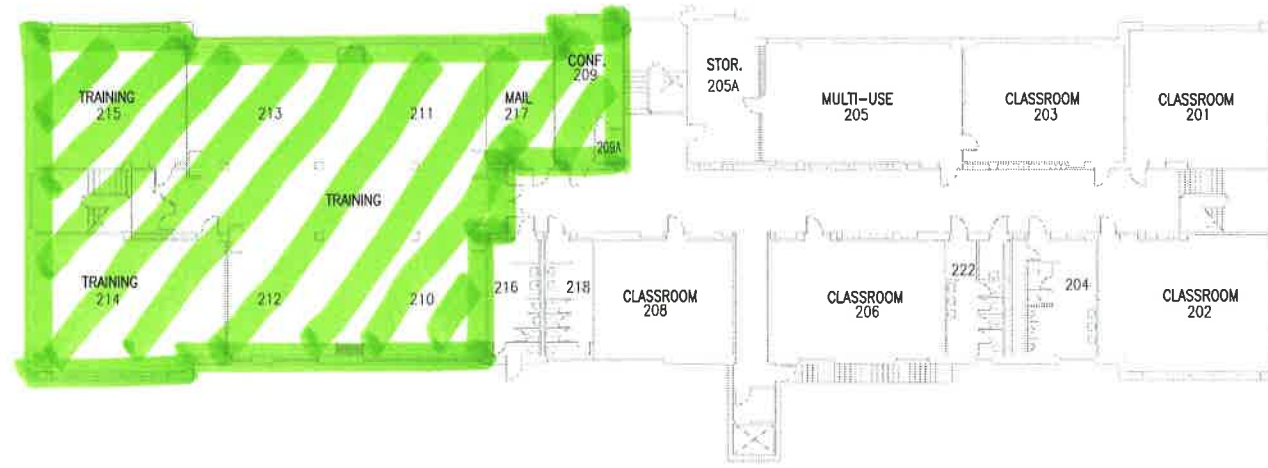

SECOND FLOOR PLAN
SCALE: 1/16" = 1'-0"
NORTH

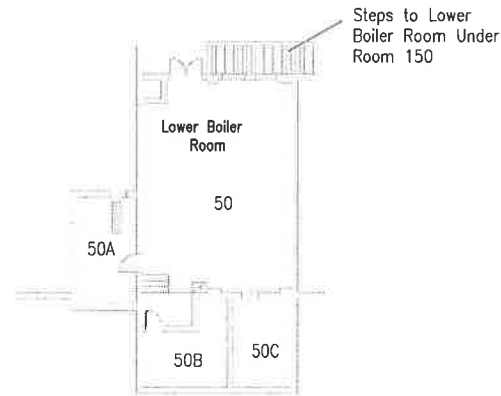

BOILER ROOM PLAN
SCALE: 1/16" = 1'-0"
NORTH

PROJ. NO.	485
DATE	01/04/17
PLOT SCALE	
DRAWN	JES
CHECKED	WSF
REVIEWED	
REVISION	11/21/16

FLOOR PLANS

DRAWING NO.
A2 485
2 OF 2